

This drawing is confidential and must not be reproduced or used without the consent of EXM

Tolerance ±1/32" unless otherwise specified

C:\Vault Workspace\Inventor Dwg\BoxCad\Result\5412EAL602412\5412EAL602412.idw

Tolérance ±1/32" sauf spécification contraire

Ce dessin est confidentiel et ne doit pas être reproduit ou utilisé sans le consentement de EXM

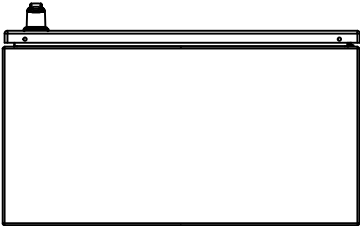

TOP

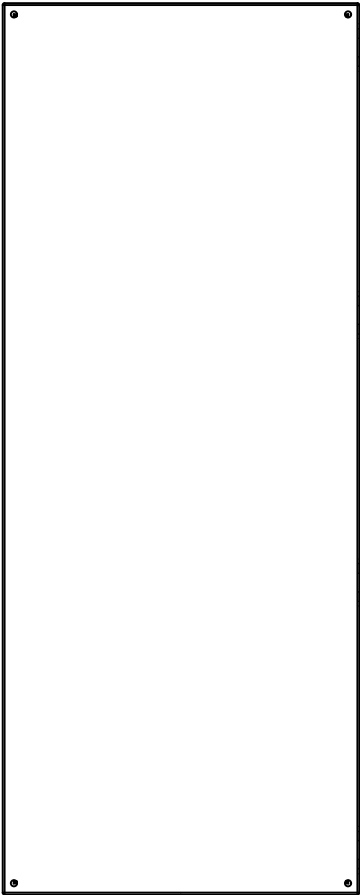

BACK

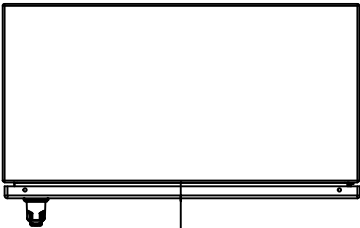

BOTTOM

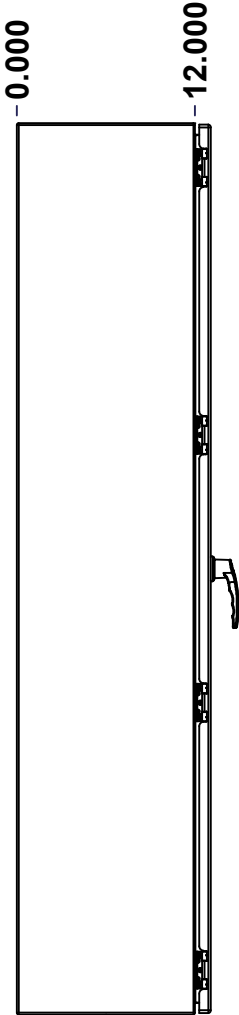

LEFT

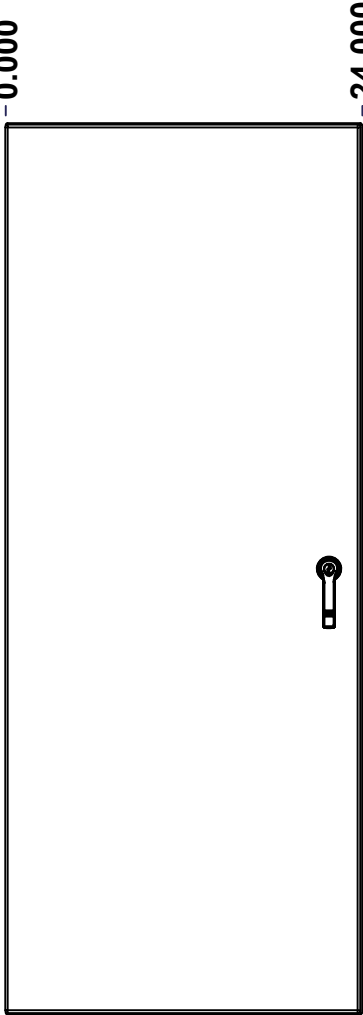

FRONT

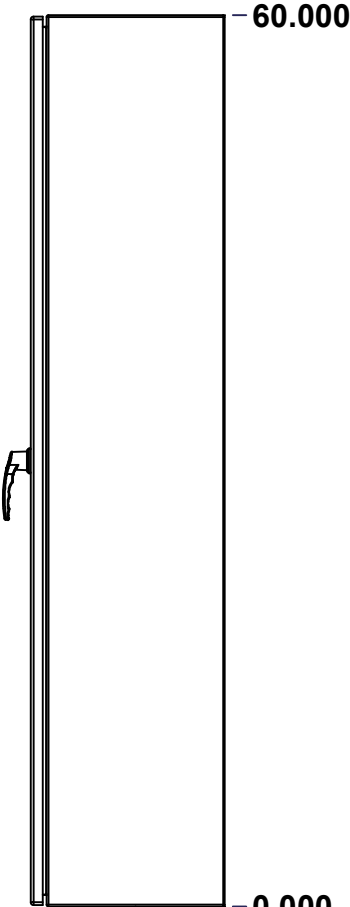

RIGHT

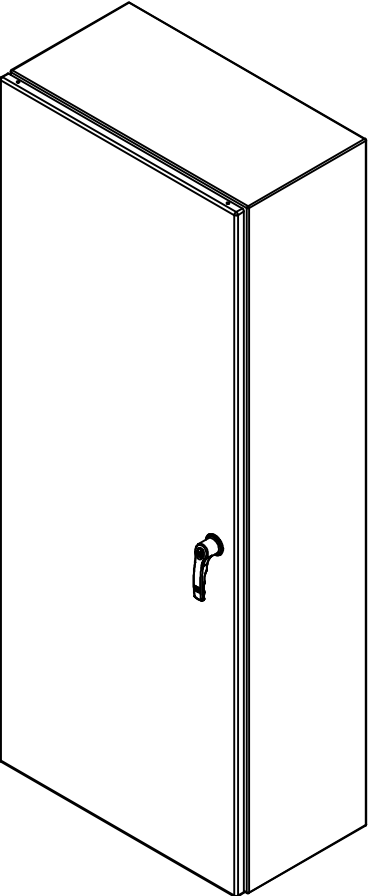

Isometric View



Tél: (450) 979-4373
Fax: (450) 979-4626
www.exmweb.com

Flatness
Aplatissement

Max 3.0mm

Projection

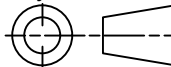

Customer
Client

Date

Drawn By
Dessiné Par

BoxCad: BoxCad

Date 05-Sep-14

Material
Matière

Aluminum 5052-H32 (2.3mm)

Color
Couleur

Asa-61 Grey

Finish
Fini

Smooth

Description

5412EAL 60" x 24" x 12" Assembly

Detail Rev.

Part Number
Numéro Pièce

5412EAL602412

Rev.

1
9

SEE BILL OF MATERIAL ON LAST PAGE

This drawing is confidential and must not be reproduced or used without the consent of EXM

Tolerance ±1/32" unless otherwise specified

C:\Vault Workspace\Inventor Dwg\BoxCad\Result\5412EAL602412\5412EAL602412.idw

Tolérance ±1/32" sauf spécification contraire

NOTE	
ITEM	DESCRIPTION
1	NEMA 4X Enclosure
2	C/W Standard ground studs on box and cover
3	C/W Standard door stiffener
4	C/W Standard inner panel (Included)
5	C/W Standard inner panel mounting studs
6	C/W 880 PP included (Not installed)

No.	Revisions	Date	By/Par

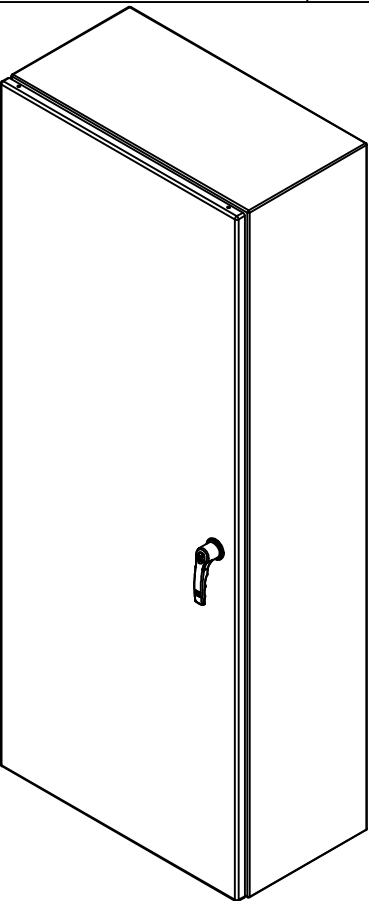

Isometric View



Tél: (450) 979-4373
Fax: (450) 979-4626
www.exmweb.com

Flatness
Aplatissement

Max 3.0mm

Projection

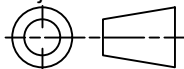

Customer Client	Date
Drawn By Dessiné Par	Date 05-Sep-14

BoxCad: BoxCad

Material Matière	Aluminum 5052-H32 (2.3mm)
---------------------	---------------------------

Color Couleur	Asa-61 Grey	Finish Fini	Smooth
------------------	-------------	----------------	--------

Description	Detail Rev.
5412EAL 60" x 24" x 12" Assembly	

Part Number Numéro Pièce	Rev.	2
5412EAL602412	0	9

PACKING		
ITEM	QTY	DESCRIPTION
Cardboard sleeve	2	Top and Bottom
Cardboard strip	2	Between back of enclosure and inner panel
Plastic bag	1	To protect cover surface and inside gasket
Cardboard corner	4	To reinforced for the plastic strap tightening
Plastic strap - Black	2	To Squeeze the 2 cardboard sleeve together
Packaging label	3	White label with PN
Plastic strap- Green	2	To secure the enclosure to the wood pallet
Wood Pallet	1	2" deeper and 3" larger than enclosure size

2	STK-Q-07310	2	Flange Lock Nut M8
1	881 SP6024G	0	881 SP - Inner Panel
2	STK-Q-07615	0	Inner Panel Support Bracket
2	STK-K-01320	0	5412 ES Inner Panel Accessory Kit
1	880 PP	6	Self Adhesive Print Pocket
1	STK-K-01800	5	5412 ES Accessory Kit
1	5412EAL602412C	0	5412EAL 60" x 24" Cover
1	5412EAL602412B	0	5412EAL 60" x 24" x 12" Body
4	STK-Q-04050-08	0	M6 x 8mm Hexagon Socket Head Machine Screw
Qty	Part Number	Rev	Description
Parts List			

This drawing is confidential and must not be reproduced or used without the consent of EXM

Tolerance ±1/32" unless otherwise specified

C:\Vault Workspace\Inventor Dwg\BoxCad\Result\5412EAL602412\5412EAL602412.idw

Tolérance ±1/32" sauf spécification contraire

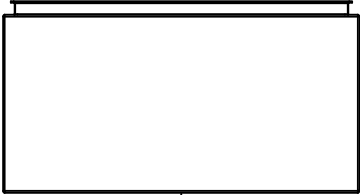

TOP

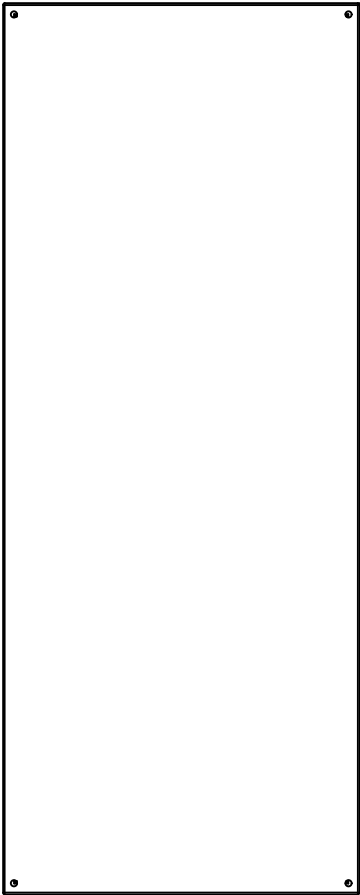

BACK

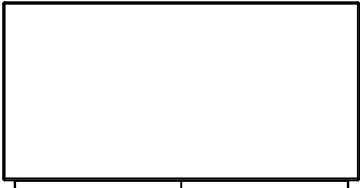

BOTTOM

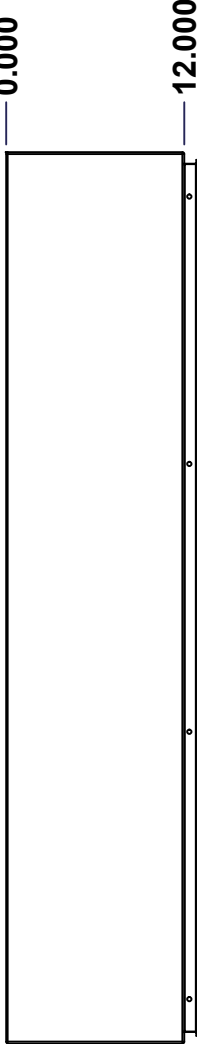

LEFT

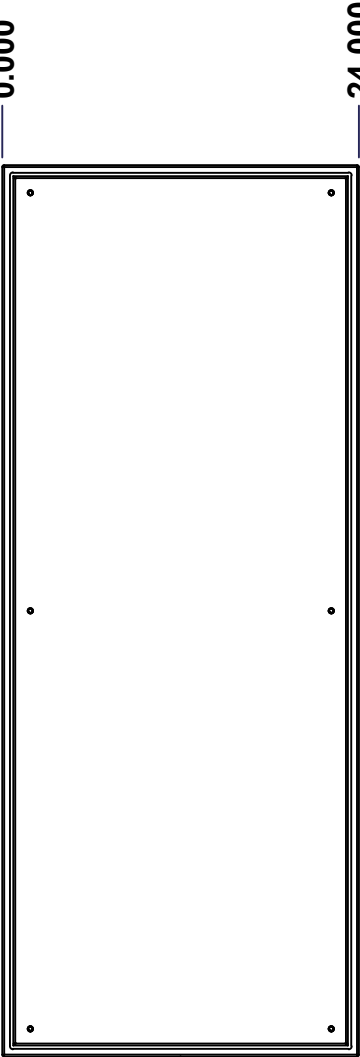

FRONT

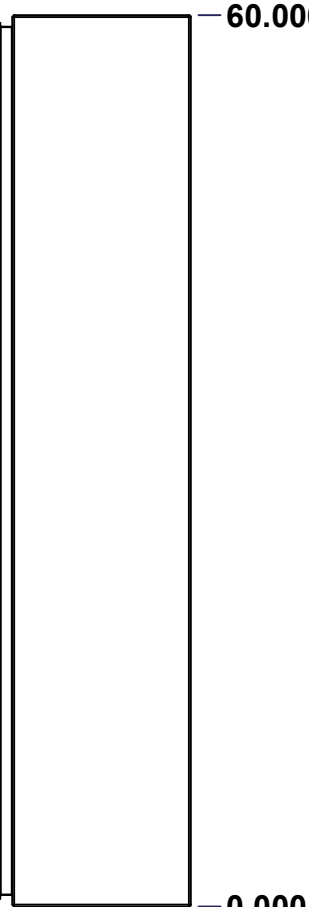

RIGHT

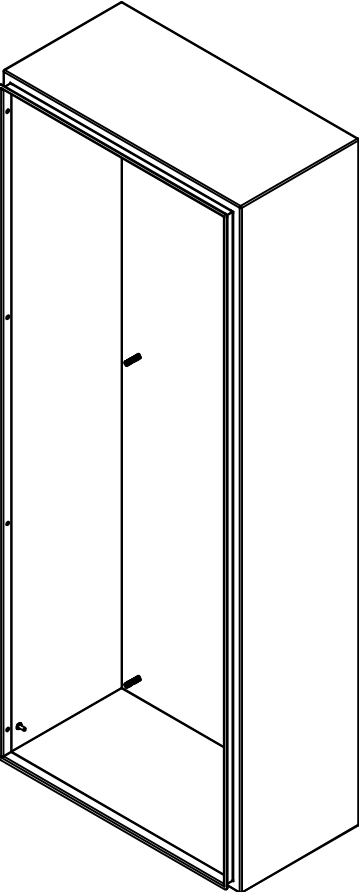

Isometric View

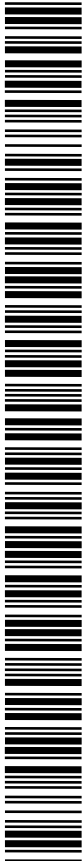

Ce dessin est confidentiel et ne doit pas être reproduit ou utilisé sans le consentement de EXM



Tél: (450) 979-4373
Fax: (450) 979-4626
www.exmweb.com

Flatness
Aplatissement

Max 3.0mm

Projection

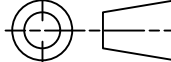

Customer
Client

Date

Drawn By
Dessiné Par

BoxCad: BoxCad

Date 05-Sep-14

Material
Matière

Aluminum 5052-H32 (2.3mm)

Color
Couleur

Asa-61 Grey

Finish
Fini

Smooth

Description

5412EAL 60" x 24" x 12" Body

Detail Rev.

Part Number
Numéro Pièce

5412EAL602412B

Rev.

3

0

9

SEE BILL OF MATERIAL ON LAST PAGE

This drawing is confidential and must not be reproduced or used without the consent of EXM

Tolerance ±1/32" unless otherwise specified

C:\Vault Workspace\Inventor Dwg\BoxCad\Result\5412EAL602412\5412EAL602412.idw

Tolérance ±1/32" sauf spécification contraire

STANDARD FEATURES ARE NOT LISTED IN THIS HOLE TABLE			
HOLE TABLE - LEFT VIEW (CUSTOM FEATURE ONLY)			
CUT-OUT	XDIM	YDIM	DESCRIPTION
1	10.500	2.000	GND STUD M6 x 16mm (Inside)

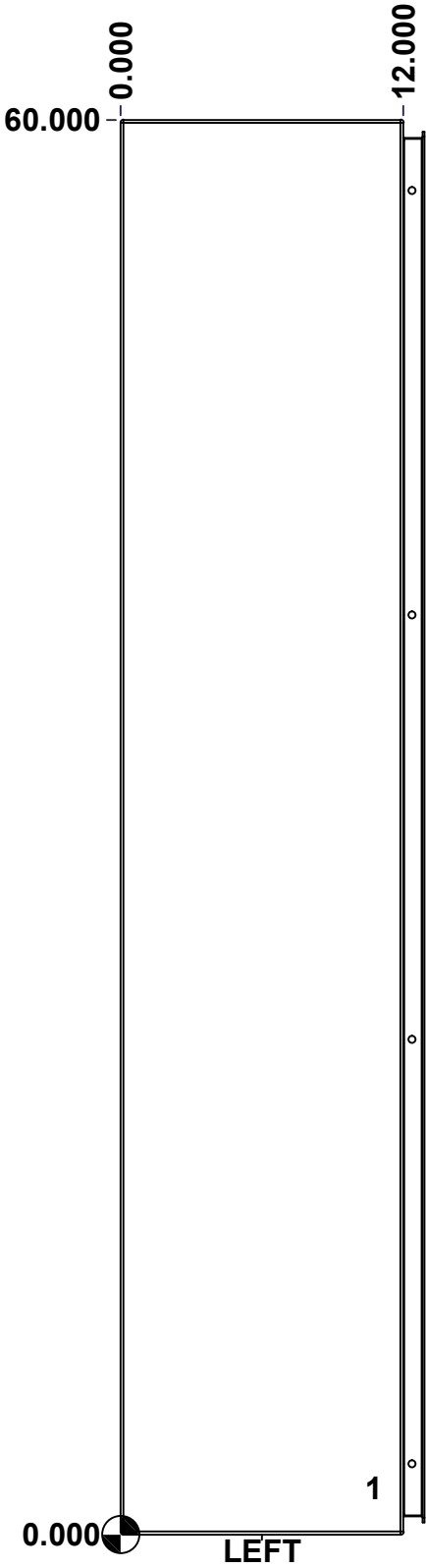

	Description	Status	
	5412EAL 60" x 24" x 12" Body	(NULL)	
	Part Number Numéro Pièce	Rev.	
	5412EAL602412B	0	4 9

Ce dessin est confidentiel et ne doit pas être reproduit ou utilisé sans le consentement de EXM

Ce dessin est confidentiel et ne doit pas être reproduit ou utilisé sans le consentement de EXM

Technical drawing showing the back view of a rectangular object. The drawing includes the following dimensions and labels:

- Top Dimensions:**
 - Overall width: 24.000
 - Inner width: 22.500
 - Thickness (right side): 0.750
- Right Side Dimensions:**
 - Overall height: 60.000
 - Inner height: 58.500
 - Thickness (bottom right): 0.750
- Internal Features and Labels:**
 - A vertical line on the left is labeled **5**.
 - A vertical line on the right is labeled **6**.
 - A horizontal line at the bottom is labeled **BACK**.
 - Points are numbered: **1** (bottom left corner), **2** (top left corner), **3** (top right corner), **4** (bottom right corner), **7** (bottom right corner, near the corner), and **8** (top right corner, near the corner).

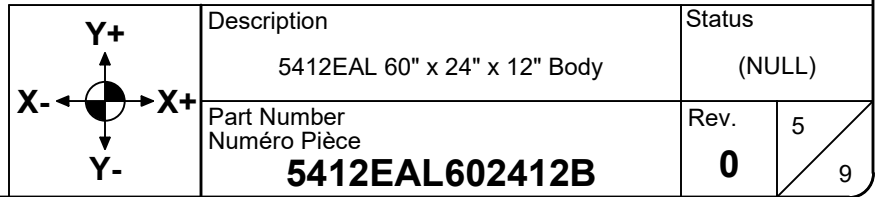

This drawing is confidential and must not be reproduced or used without the consent of EXM

Tolerance ±1/32" unless otherwise specified

C:\Vault Workspace\Inventor Dwg\BoxCad\Result\5412EAL602412\5412EAL602412.idw

Tolérance ±1/32" sauf spécification contraire

No.	Revisions	Date	By/Par

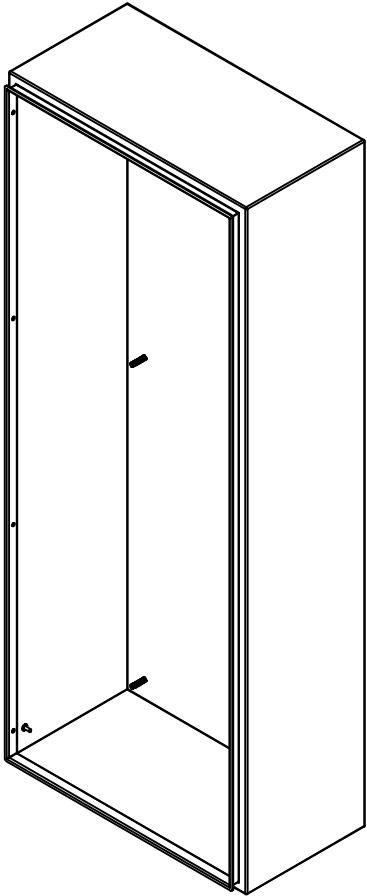

Isometric View

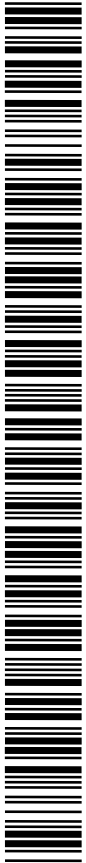

Ce dessin est confidentiel et ne doit pas être reproduit ou utilisé sans le consentement de EXM



Tél: (450) 979-4373
Fax: (450) 979-4626
www.exmweb.com

Flatness
Aplatissement

Max 3.0mm

Projection

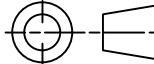

Customer Client	Date
--------------------	------

Drawn By Dessiné Par	BoxCad: BoxCad	Date 05-Sep-14
-------------------------	----------------	----------------

Material Matière	Aluminum 5052-H32 (2.3mm)
---------------------	---------------------------

Color Couleur	Asa-61 Grey	Finish Fini	Smooth
------------------	-------------	----------------	--------

Description	Detail Rev.
5412EAL 60" x 24" x 12" Body	

Part Number Numéro Pièce	Rev.	6
5412EAL602412B	0	9

1	STK-Q-16090	0	Ground Stud M6 x 16mm Aluminum
1	STK-P-02400S	0	Powder Paint (Asa-61 Grey / Smooth)
6	STK-Q-16010	0	Stud M8 x 35mm Aluminum
1	5412EAL602412B-P	0	5412EAL 60" x 24" x 12" Body Part
Qty	Part Number	Rev	Description
Parts List			

This drawing is confidential and must not be reproduced or used without the consent of EXM

Tolerance ±1/32" unless otherwise specified

C:\Vault Workspace\Inventor Dwg\BoxCad\Result\5412EAL602412\5412EAL602412.idw

Tolérance ±1/32" sauf spécification contraire

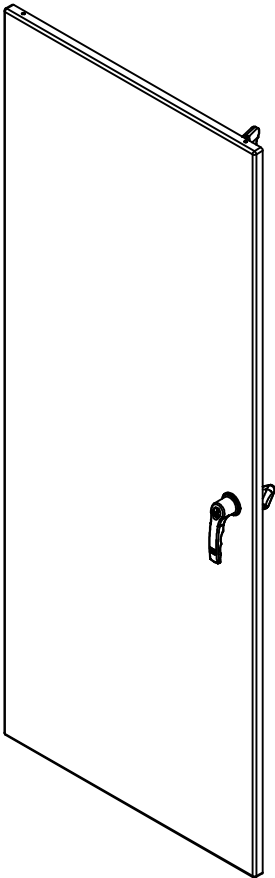
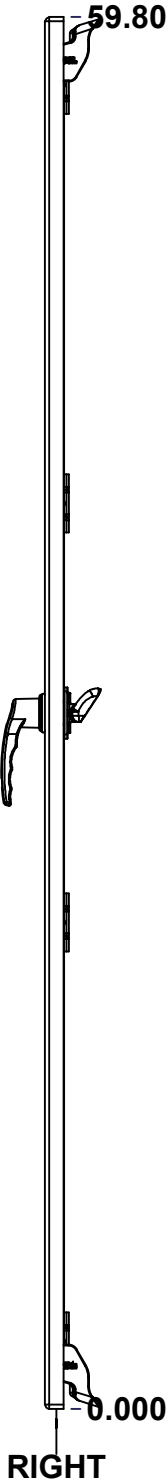
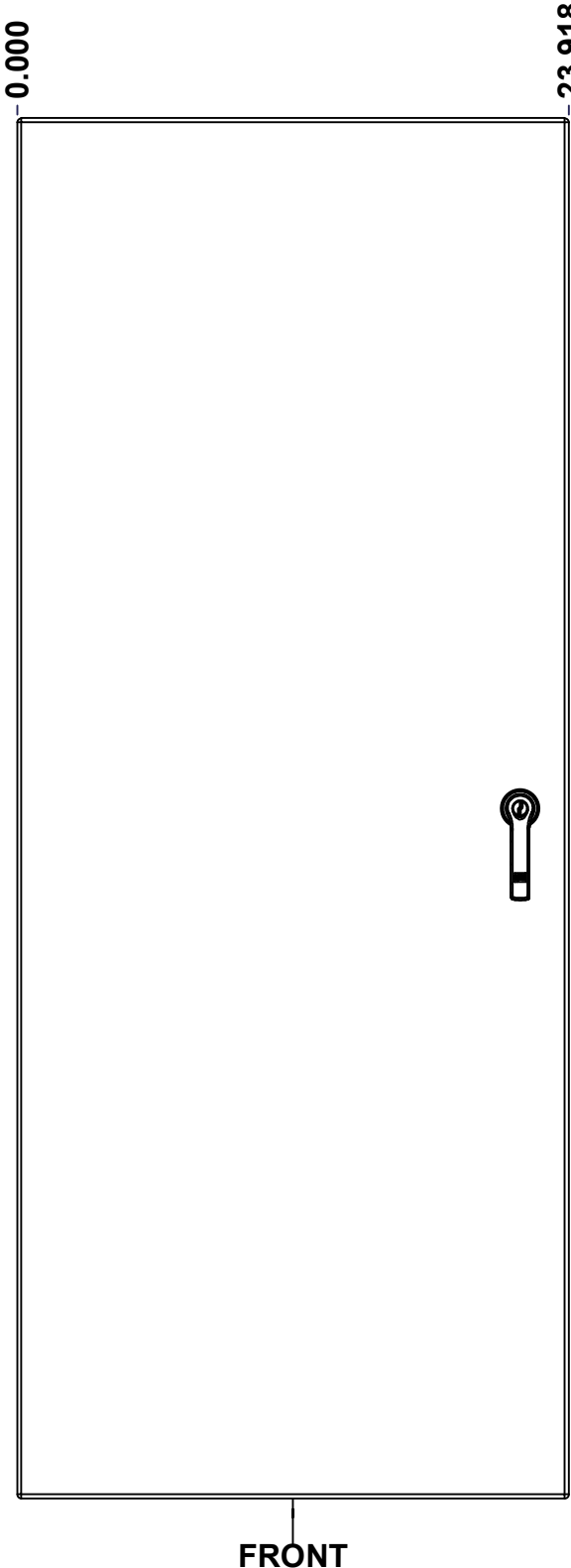
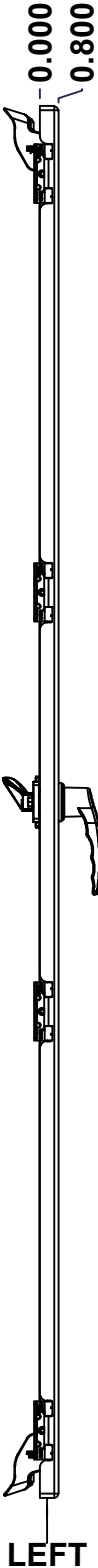
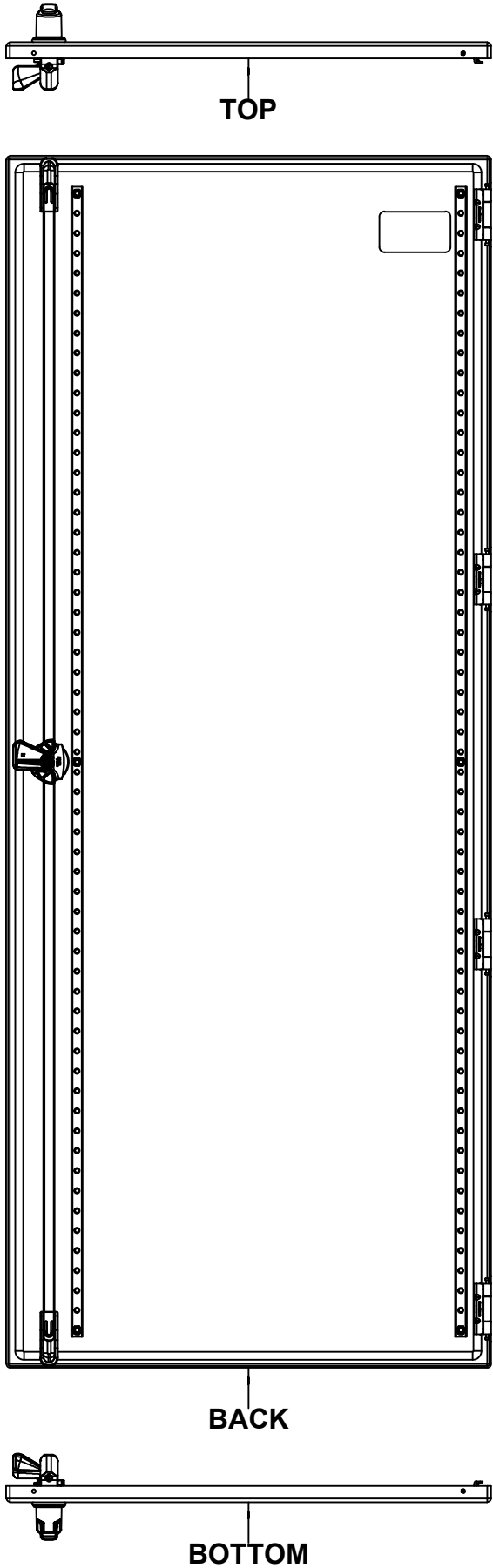

Isometric View

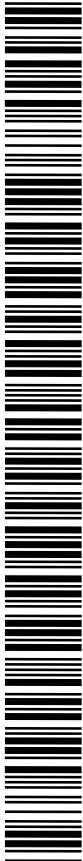

Ce dessin est confidentiel et ne doit pas être reproduit ou utilisé sans le consentement de EXM



Tél: (450) 979-4373
Fax: (450) 979-4626
www.exmweb.com

Flatness
Aplatissement

Max 3.0mm

Projection

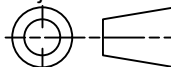

Customer
Client

Date

Drawn By
Dessiné Par

BoxCad: BoxCad

Date 05-Sep-14

Material
Matière

Aluminum 5052-H32 (2.3mm)

Color
Couleur

Asa-61 Grey

Finish
Fin

Smooth

Description

5412EAL 60" x 24" Cover

Detail Rev.

Part Number
Numéro Pièce

5412EAL602412C

Rev.

7

0

9

SEE BILL OF MATERIAL ON LAST PAGE

This drawing is confidential and must not be reproduced or used without the consent of EXM

Tolerance ±1/32" unless otherwise specified

C:\Vault Workspace\Inventor Dwg\BoxCad\Result\5412EAL602412\5412EAL602412.idw

Tolérance ±1/32" sauf spécification contraire

STANDARD FEATURES ARE NOT LISTED IN THIS HOLE TABLE			
HOLE TABLE - FRONT VIEW (CUSTOM FEATURE ONLY)			
CUT-OUT	XDIM	YDIM	DESCRIPTION
1	1.486	1.850	STUD M6 x 18mm (Inside)
2	1.486	57.953	STUD M6 x 18mm (Inside)
3	20.423	57.953	STUD M6 x 18mm (Inside)
4	20.423	1.850	STUD M6 x 18mm (Inside)
5	1.486	29.902	STUD M6 x 18mm (Inside)
6	20.423	29.902	STUD M6 x 18mm (Inside)
7	21.803	54.896	CLOSING BAR STUD (Inside)
8	21.803	4.907	CLOSING BAR STUD (Inside)
-----	-----	-----	-----
9	3.750	56.053	LABEL_EXM (Inside)
10	21.803	29.902	885 ESL2A

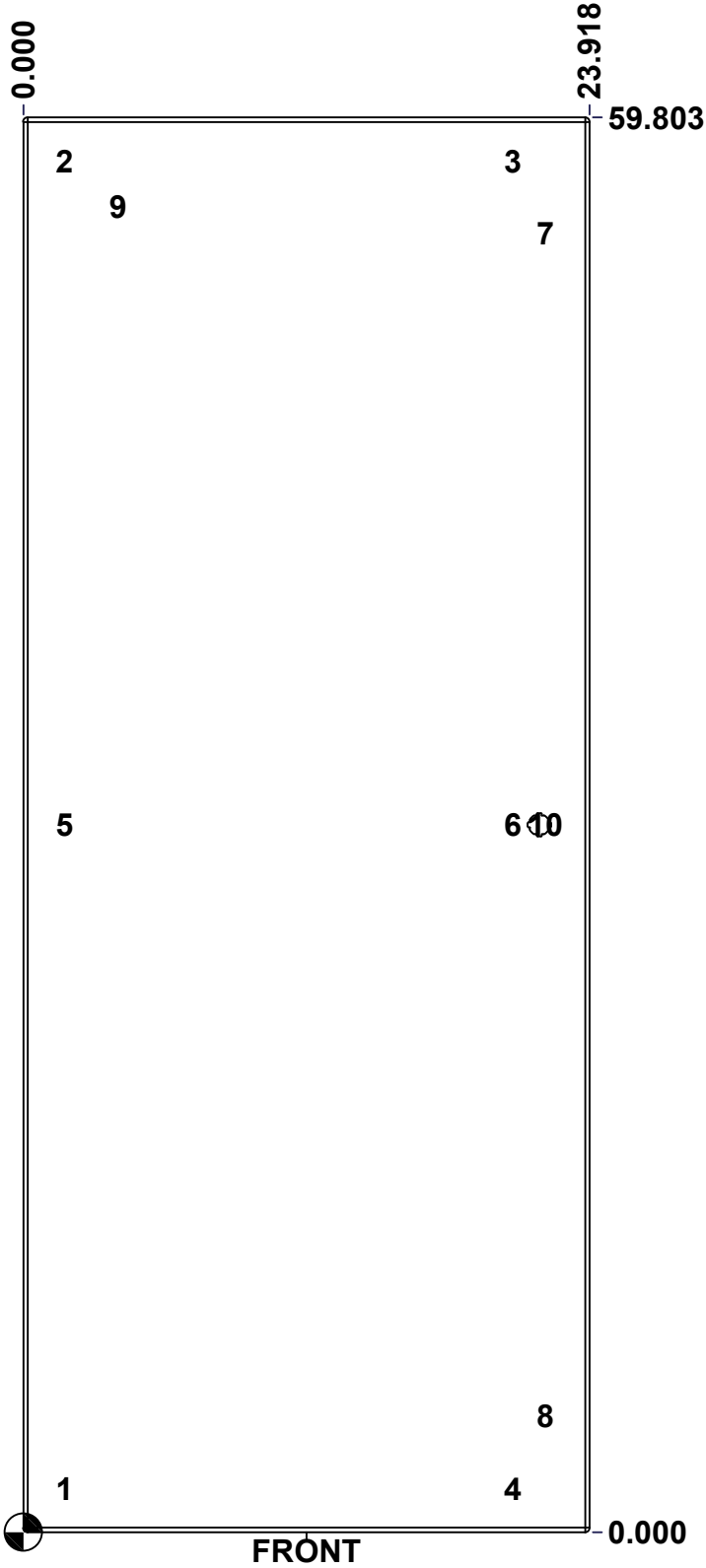

	Description	Status	
	5412EAL 60" x 24" Cover	(NULL)	
	Part Number	Rev.	8 / 9
	Numéro Pièce 5412EAL602412C	0	

Ce dessin est confidentiel et ne doit pas être reproduit ou utilisé sans le consentement de EXM

This drawing is confidential and must not be reproduced or used without the consent of EXM

Tolerance ±1/32" unless otherwise specified

C:\Vault Workspace\Inventor Dwg\BoxCad\Result\5412EAL602412\5412EAL602412.idw

Tolérance ±1/32" sauf spécification contraire

No.	Revisions	Date	By/Par

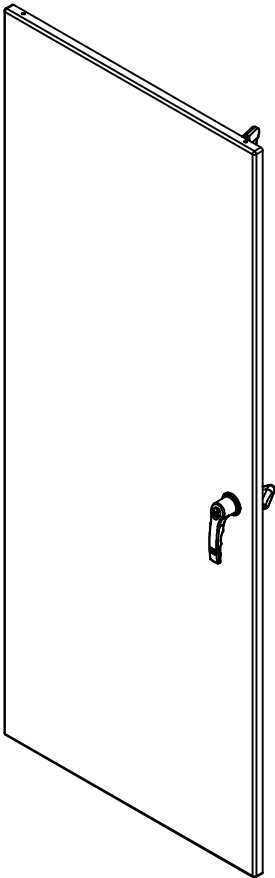

Isometric View

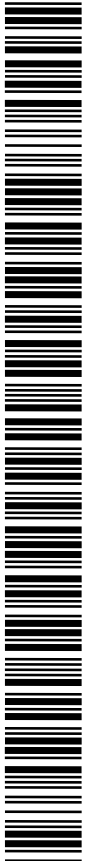

2	STK-Q-90042	4	5412 ES - Cabinet Closing Bar End (Small)
2	STK-Q-45655-60	0	5412 ES - Closing Bar
1	STK-Q-50536	13	5412 ES - Handle Cam Clockwise (Grip 32mm)
1	STK-Q-90051	2	5412 ES - Handle Cam Spacer
1	885 ESL2A	4	5412 ES Key Lock L-Handle (3 Pts)
1	STK-S-00100	0	3.5" x 2" Silver Milar Flexcon Sticker
1	STK-P-02400S	0	Powder Paint (Asa-61 Grey / Smooth)
2	STK-Q-46020-60	5	5412 ES Vertical Door Stiffener 60"
2	STK-Q-16406	2	Guide Stud - Small (No Paint Cap Required)
6	STK-Q-16060	0	Stud M6 x 18mm Aluminum
1	5412EAL602412G	0	5412EAL 60" x 24" Cover Gasket Part
1	5412EAL602412C-P	0	5412EAL 60" x 24" Cover Part
4	STK-A-33016	0	5412 ESS Bended Hinge (Body Part)
6	STK-Q-07220	1	M6 Nylon Insert Lock Nut
Qty	Part Name	Rev	Description
Parts List			



Tél: (450) 979-4373
Fax: (450) 979-4626
www.exmweb.com

Flatness
Aplatissement
Max 3.0mm

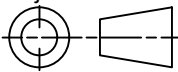
Projection

Customer Client
Date

Drawn By
Dessiné Par
BoxCad: BoxCad
Date 05-Sep-14

Material
Matière
Aluminum 5052-H32 (2.3mm)

Color
Couleur
Asa-61 Grey
Finish
Fini
Smooth

Description
5412EAL 60" x 24" Cover
Detail Rev.

Part Number
Numéro Pièce
5412EAL602412C
Rev. 0
9

Ce dessin est confidentiel et ne doit pas être reproduit ou utilisé sans le consentement de EXM

This drawing is confidential and must not be reproduced or used without the consent of EXM

Tolerance $\pm 1/32$ " unless otherwise specified

C:\Vault Workspace\Inventor Dwg\Inv-8\881SP\881SP6024G.idw

Tolérance $\pm 1/32$ " sauf spécification contraire

Ce dessin est confidentiel et ne doit pas être reproduit ou utilisé sans le consentement de EXM

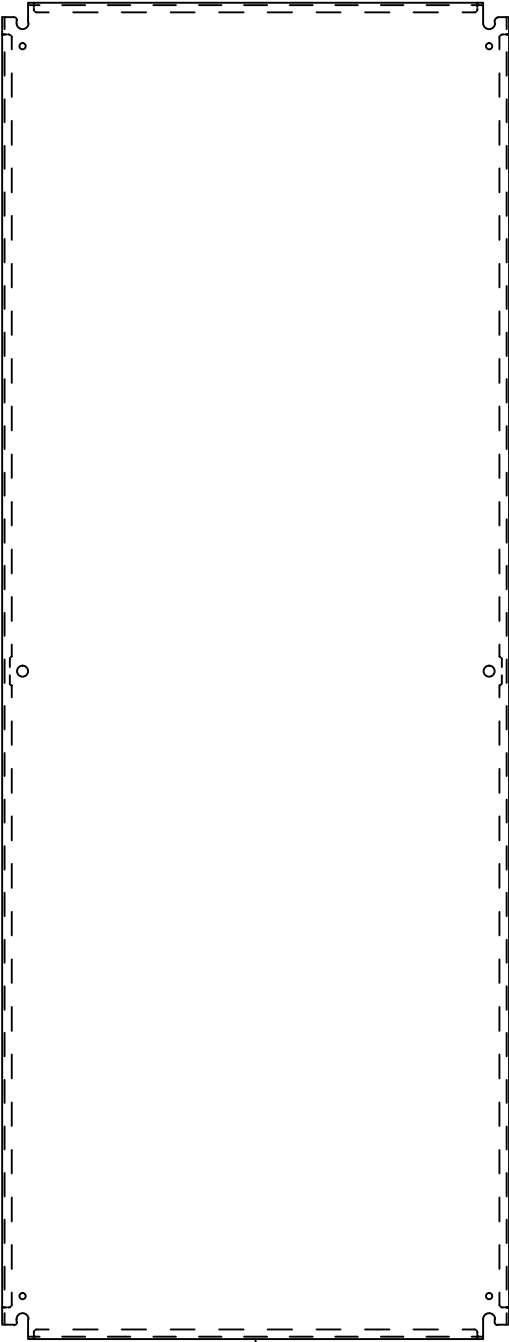
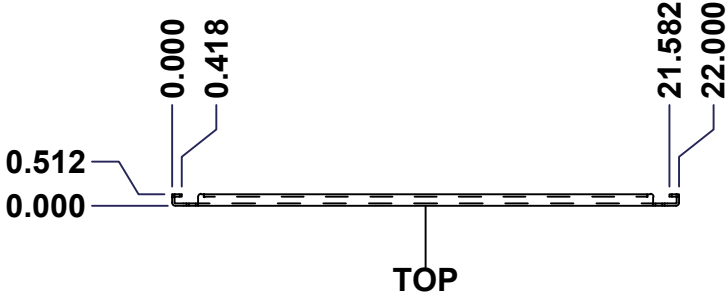

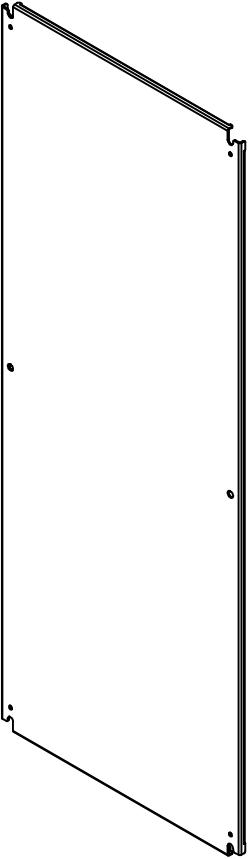
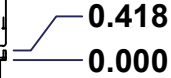
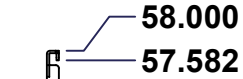

FRONT

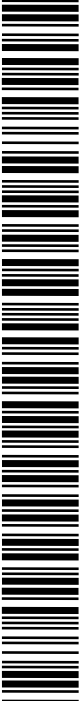

Isometric View

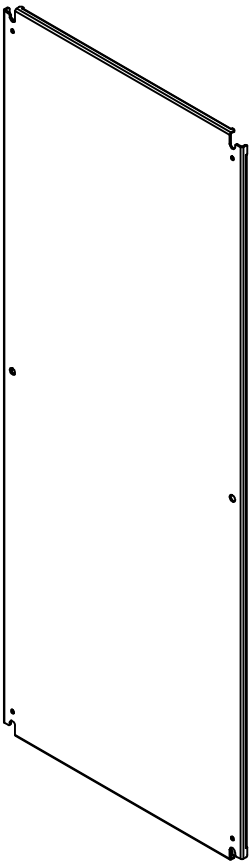
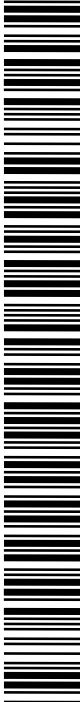

1	881 SP6024G-P	0	881 SP - Inner Panel Part	12 Ga Galvanized	Unpainted	Galvanized
Qty	Part Number	Rev	Description	Material	Color	Finish
Parts List						

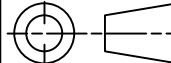
No.	Revisions	Date	By/Par
<div><p>Isometric View</p></div>			
<div><div>Tél: (450) 979-4373 Fax: (450) 979-4626 www.exmweb.com</div></div>		<div>Flatness Aplatissement</div> <div> Max 3.0mm</div> <div>Projection</div> <div></div>	
Customer Client		Date	
Drawn By Dessiné Par BoxCad		Date 23-Jan-07	
Material Matière		See Part List	
Color Couleur See Part List		Finish Fini See Part List	
Description		Detail Rev.	
881 SP - Inner Panel			
Part Number Numéro Pièce		Rev.	1
881 SP6024G		0	2

This drawing is confidential and must not be reproduced or used without the consent of EXM

Tolerance ±1/32" unless otherwise specified

C:\Vault Workspace\Inventor Dwg\Inv-8\881SP\881SP6024G.idw

Tolérance ±1/32" sauf spécification contraire

Table 1			FRONT VIEW
CUT-OUT	XDIM	YDIM	DESCRIPTION
1	0.875	1.875	GROUND HOLE (RND Ø0.290)
2	21.125	1.875	GROUND HOLE (RND Ø0.290)
3	0.875	56.125	GROUND HOLE (RND Ø0.290)
4	21.125	56.125	GROUND HOLE (RND Ø0.290)
5	0.875	29.000	MTG STUD HOLE (RND Ø0.500)
6	21.125	29.000	MTG STUD HOLE (RND Ø0.500)

All knockouts are actual size / Les disques défonçables sont grandeur réel

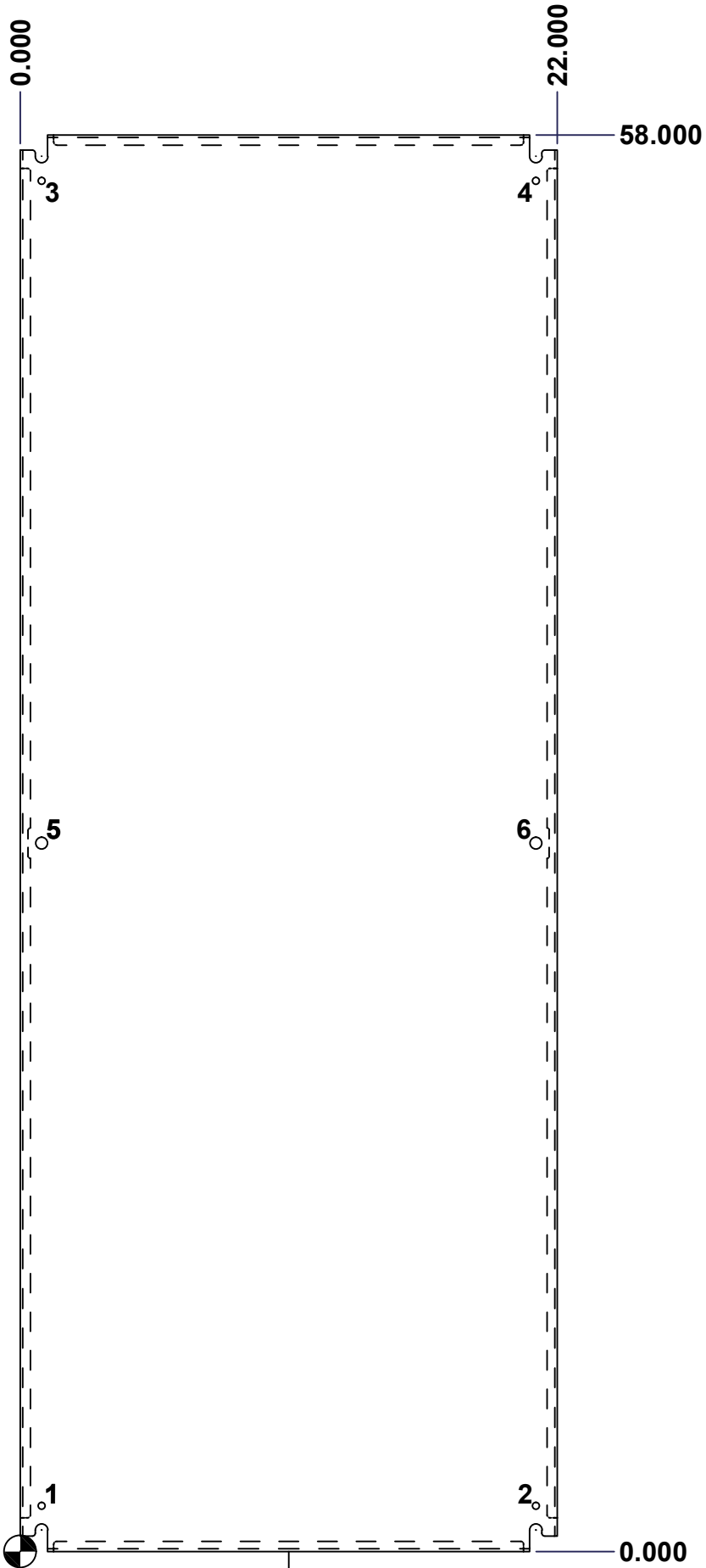

No.	Revisions	Date	By/Par

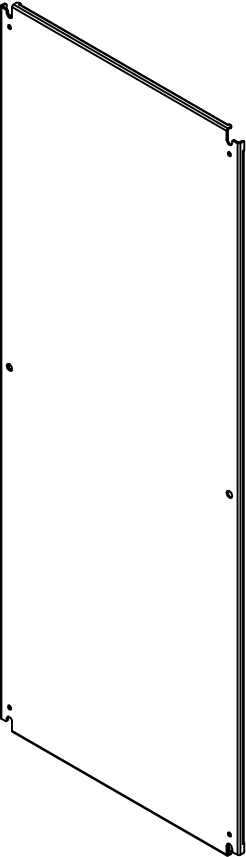

Isometric View

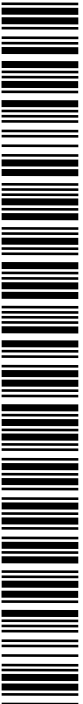

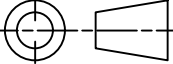
 Tél: (450) 979-4373 Fax: (450) 979-4626 www.exmweb.com		Flatness Aplatissement Max 3.0mm Projection 	
Customer Client		Date	
Drawn By Dessiné Par BoxCad		Date 23-Jan-07	
Material Matière		See Part List	
Color Couleur		See Part List	Finish Finis See Part List
Description 881 SP - Inner Panel			Detail Rev.
Part Number Numéro Pièce 881 SP6024G		Rev. 0	2 2

Ce dessin est confidentiel et ne doit pas être reproduit ou utilisé sans le consentement de EXM